

PCMK	QTY	MAIN MATERIAL	LENGTH	DESCRIPTION	WEIGHT	POUNDS
1B1	1	W24x68	21-0 13/16	BEAM	1831	9281.95
1B2	1	W12x45	22-3	BEAM	998.1	
1B3	1	W30x99	24-1 5/16	BEAM	2379.22	
1B4	1	W12x50	25-2	BEAM	1254.62	
1B5	1	W24x68	19-7 7/8	BEAM	1614.26	
1B6	1	W12x45	20-4 11/16	BEAM	1204.75	
2M1	6	WT7x37	16-3	MISC	3607.5	6051.5
2M2	1	WT13.5x57	16-3	MISC	926.25	
2M3	1	WT9x35.5	5-0	MISC	176.15	
2M4	1	WT7x24	5-0	MISC	119.6	
2M5	1	WT13.5x57	16-3	MISC	926.25	
2M6	1	WT9x35.5	5-0	MISC	176.15	
2M7	1	WT7x24	5-0	MISC	119.6	
2M8	12	HSS5x3x5/16	10-0	MISC	2386.8	
2P1	2	PL3/4x9	10-0	MISC	459.38	4588.52
2P2	2	PL3/4x9	6-3	MISC	287.1	
2P3	4	PL3/4x9	5-6	MISC	505.32	
2P4	4	PL3/4x9	5-6	MISC	499.4	
2P5	2	PL3/4x9	2-0	MISC	88.3	
2P6	4	FL3/8x4	1-3	MISC	22.6	
2P7	6	FL3/8x4	9	MISC	20.34	
2P8	2	FL3/8x4	1-9	MISC	15.8	
3P1	8	PL3/4x3 3/4	6 5/16	MISC	39.52	
3P2	8	PL3/4x3 3/4	6 5/16	MISC	39.52	
3P3	8	PL3/4x3 3/4	7	MISC	43.68	
3P4	8	PL3/4x3 3/4	7	MISC	43.68	
3P5	4	PL3/4x3 3/4	5 1/2	MISC	17.2	
3P6	4	PL3/4x3 3/4	5 1/2	MISC	17.2	
3P7	2	PL3/4x3 1/4	1-0 11/16	MISC	17.1	
3P8	2	PL3/4x3 1/4	1-0 11/16	MISC	17.1	
3P9	2	PL3/4x3 1/2	6 5/16	MISC	9.22	
3P10	2	PL3/4x3 1/2	6 5/16	MISC	9.22	
3P11	2	PL3/4x3 1/2	6 5/16	MISC	9.22	
3P12	2	PL3/4x3 1/2	6 5/16	MISC	9.22	
3P13	2	PL3/4x3 1/4	9 1/4	MISC	12.36	
3P14	2	PL3/4x2 11/16	2 11/16	MISC	3.44	
3P15	2	PL3/4x3 1/4	9 1/4	MISC	12.36	
3P16	2	PL3/4x2 11/16	2 11/16	MISC	3.44	
Total:	116			Tot Wt (lbs):	19921.97	
				Tot Wt (Tons):	9.960985	

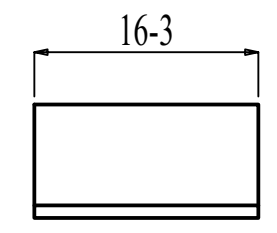

6 MISC 2M1

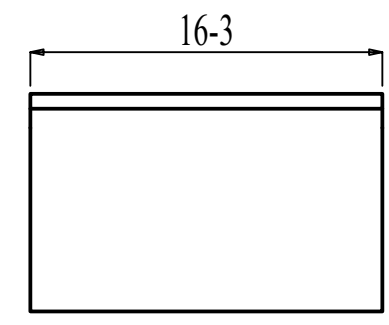

ONE MISC 2M2

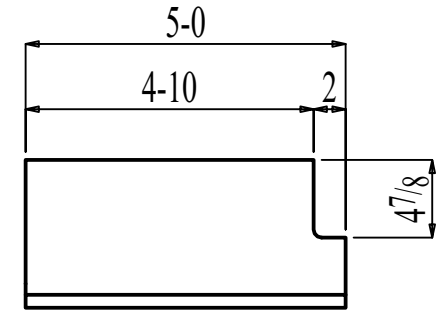

ONE MISC 2M3

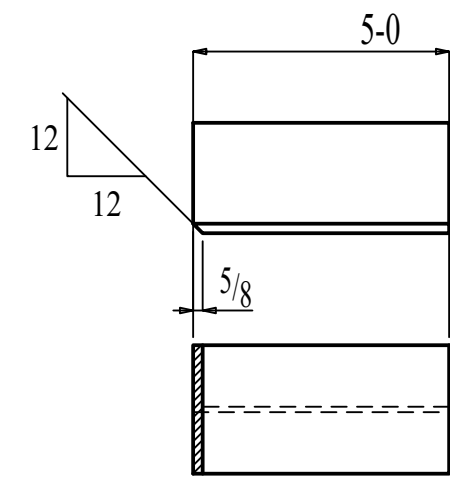

ONE MISC 2M4

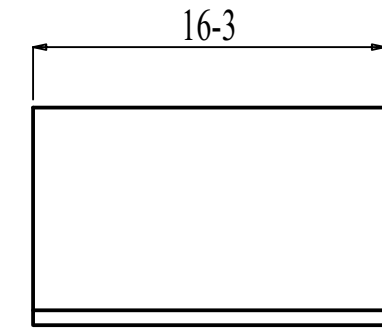

ONE MISC 2M5

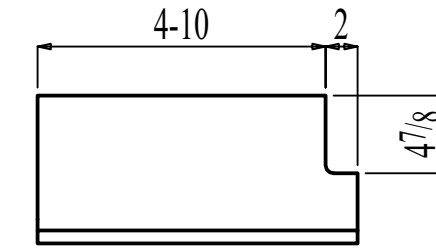

ONE MISC 2M6

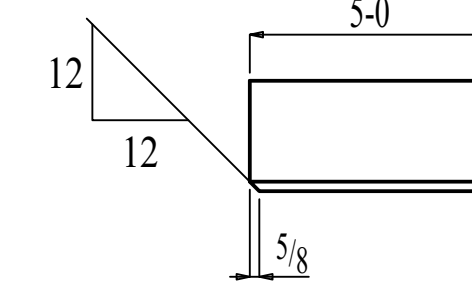

ONE MISC 2M7

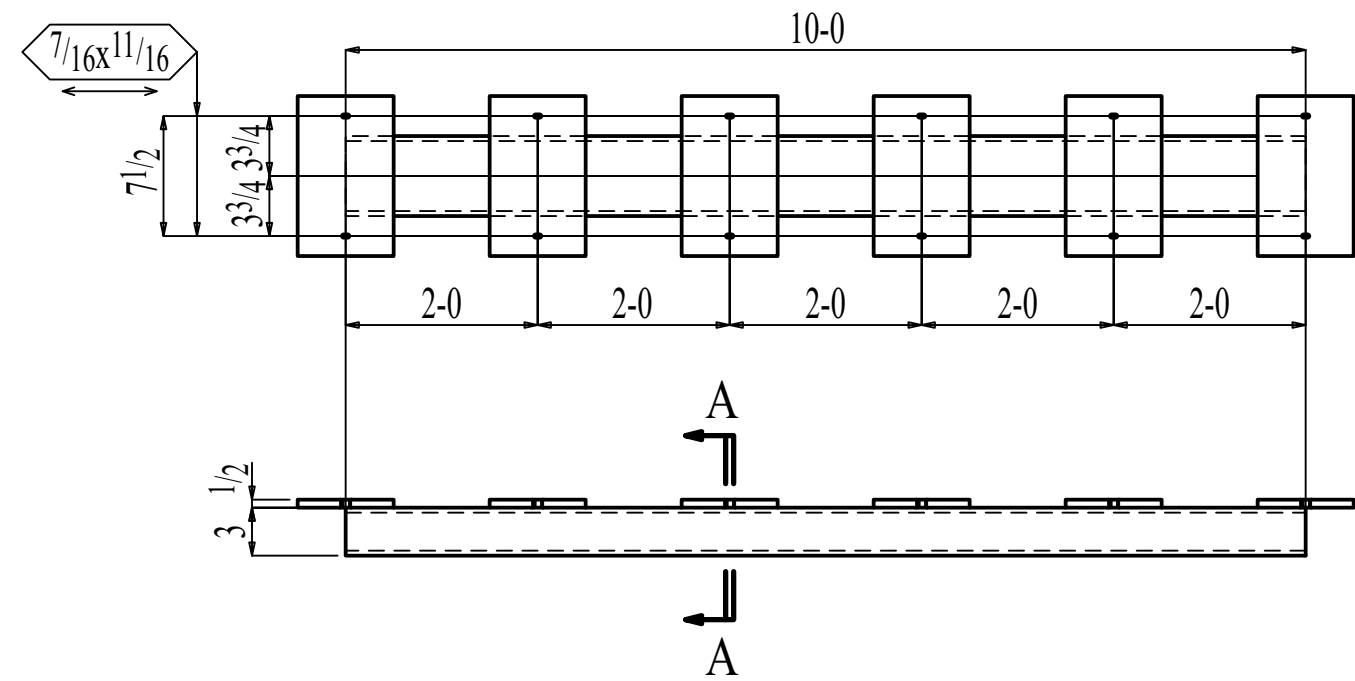

12 MISC 2M8

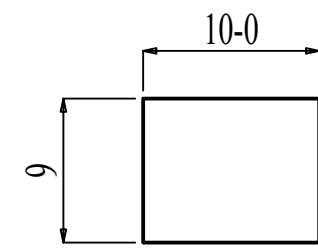
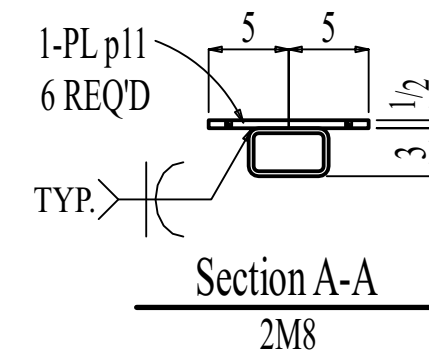

2 PLATES 2P1

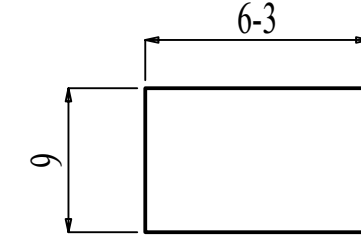

2 PLATES 2P2

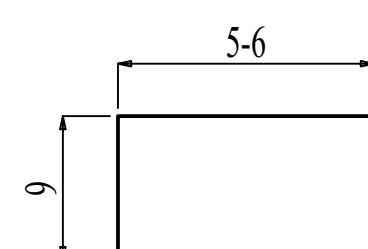

4 PLATES 2P3

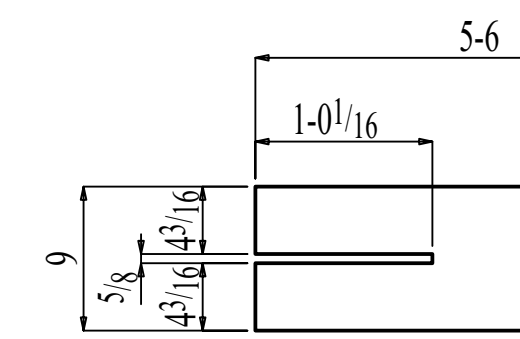

4 PLATES 2P4

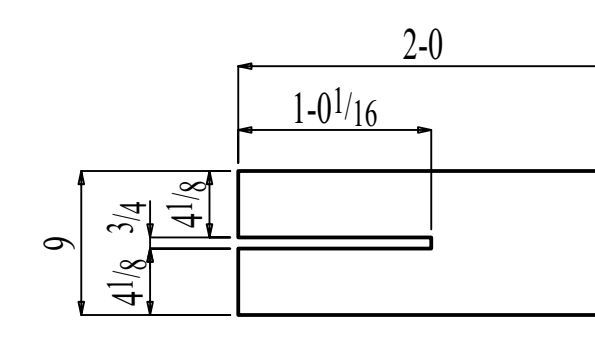

2 PLATES 2P5

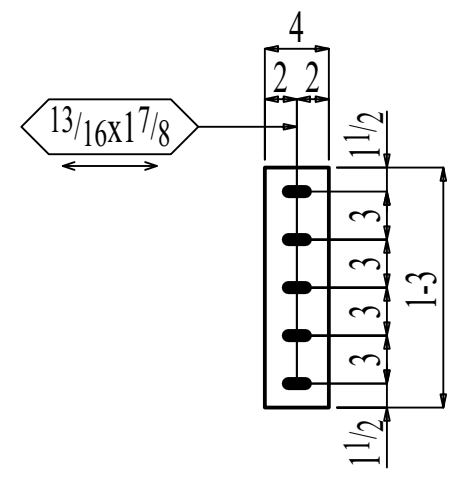

4 PLATES 2P6

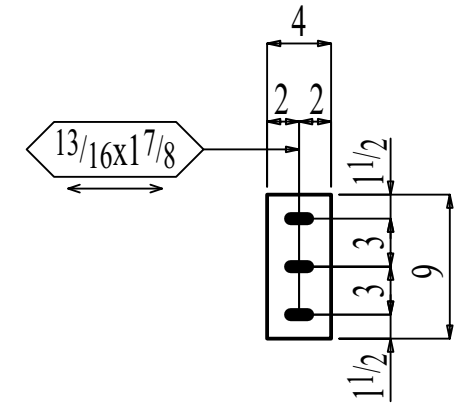

6 PLATES 2P7

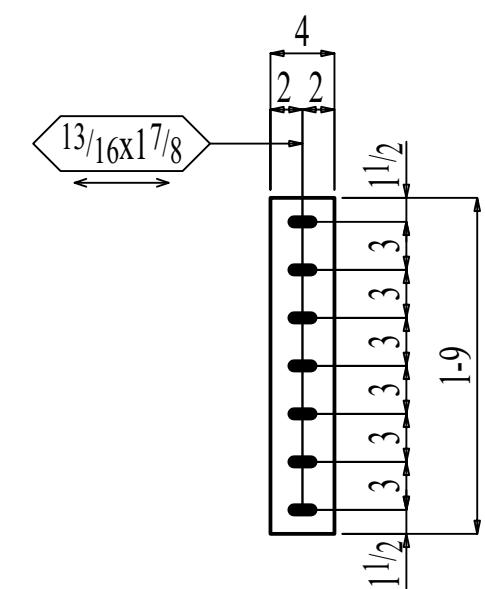

2 PLATES 2P8

BILL OF MATERIAL

LINE #	QTY	PC MARK	DESCRIPTION	LENGTH	REMARKS	WEIGHT TOTAL	ADVANCE MILL #
6	2M1	MISC				3608	
6	2M1	WT7x37	16 3	A992		3608	
ONE	2M2	MISC				926	
1	2M2	WT13.5x57	16 3	A992		926	
ONE	2M3	MISC				178	
1	2M3	WT9x35.5	5 0	A992		178	
ONE	2M4	MISC				120	
1	2M4	WT7x24	5 0	A992		120	
ONE	2M5	MISC				926	
1	2M5	WT13.5x57	16 3	A992		926	
ONE	2M6	MISC				178	
1	2M6	WT9x35.5	5 0	A992		178	
ONE	2M7	MISC				120	
1	2M7	WT7x24	5 0	A992		120	
12	2M8	MISC				2392	
12	2M8	HSS53x3 5/16	10 0	A500B		1780	
72	p11	PL 1/2x6	0 10	A36		613	
		FIELD BOLTS					
144		3/8 Dia HILTI KH-EZ A.B.	0 5				
2	2P1	PLATE				459	
2	2P1	PL 3/4x9	10 0	A36		459	
2	2P2	PLATE				287	
2	2P2	PL 3/4x9	6 3	A36		287	
4	2P3	PLATE				505	
4	2P3	PL 3/4x9	5 6	A36		505	
4	2P4	PLATE				505	
4	2P4	PL 3/4x9	5 6	A36		505	
2	2P5	PLATE				92	
2	2P5	PL 3/4x9	2 0	A36		92	
4	2P6	PLATE				23	
4	2P6	FL 3/8x4	1 3	A36		23	
6	2P7	PLATE				20	
6	2P7	FL 3/8x4	0 9	A36		20	
2	2P8	PLATE				16	
2	2P8	FL 3/8x4	1 9	A36		16	

Total weight : 10355

REV	DATE	DESCRIPTION
PROJECT NUMBER 22121		
DATE 12-5-22		
DRAWN BY KAY ENGINEERING		
CHECKED BY		
APPROVED BY		
SCALE		

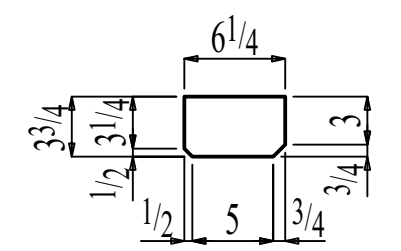

8 PLATES 3P1

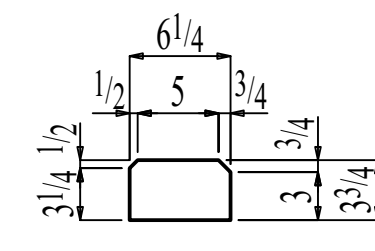

8 PLATES 3P2

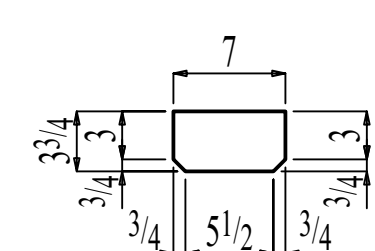

8 PLATES 3P3

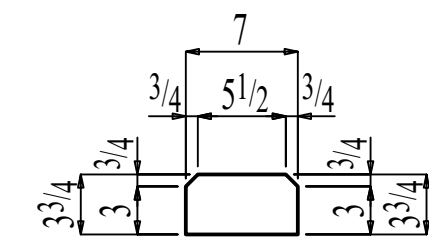

8 PLATES 3P4

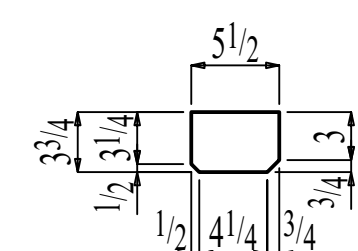

4 PLATES 3P5

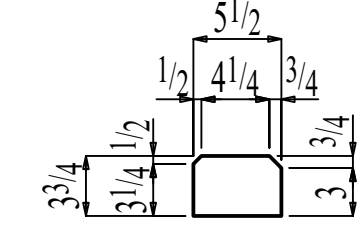

4 PLATES 3P6

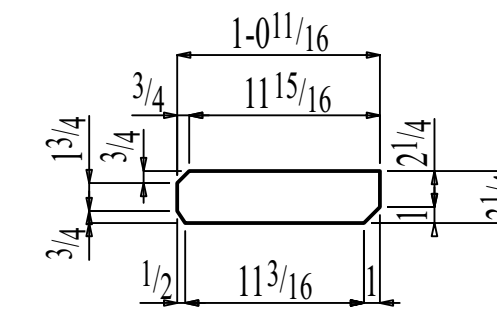

2 PLATES 3P7

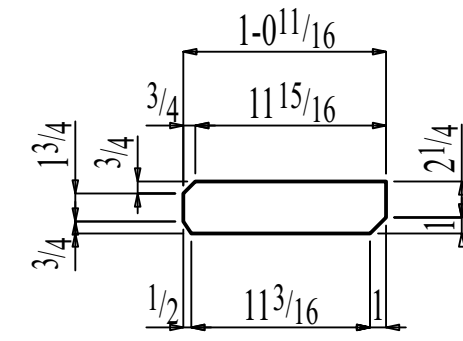

2 PLATES 3P8

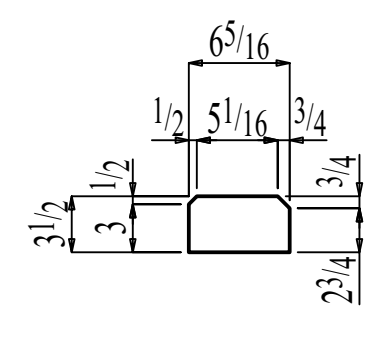

2 PLATES 3P9

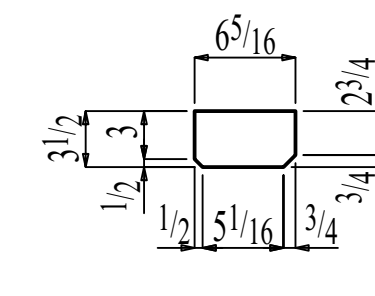

2 PLATES 3P10

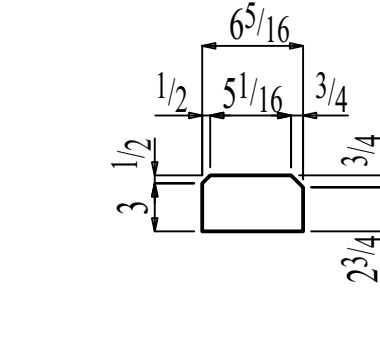

2 PLATES 3P11

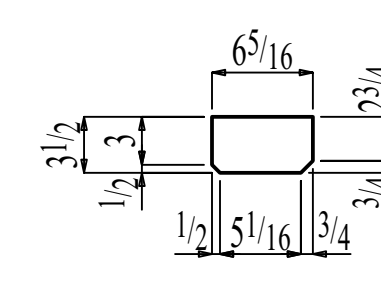

2 PLATES 3P12

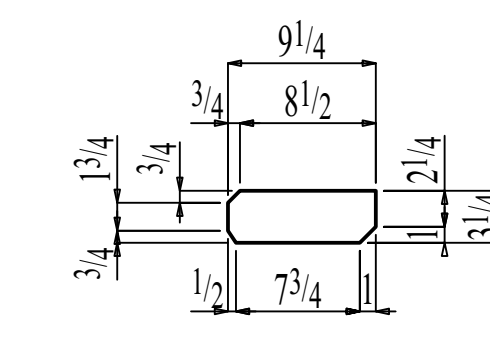

2 PLATES 3P13

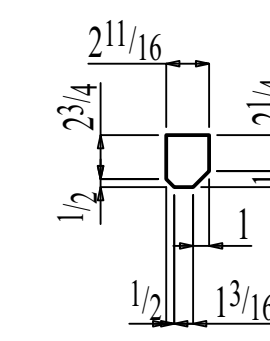

2 PLATES 3P14

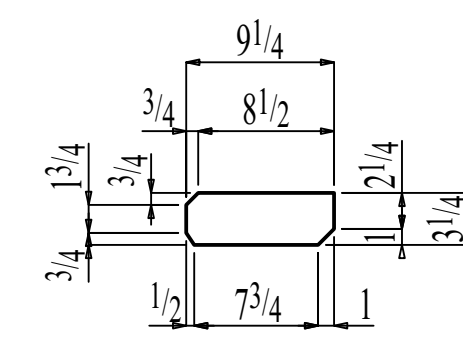

2 PLATES 3P15

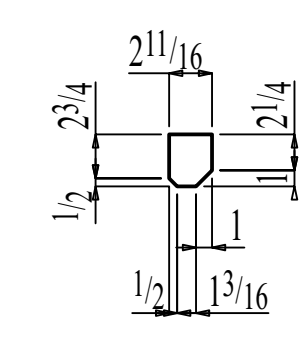

2 PLATES 3P16

BILL OF MATERIAL

LINE #	QTY	PC MARK	DESCRIPTION	LENGTH	REMARKS	WEIGHT TOTAL	ADVANCE MILL #
8	3P1		PLATE			40	
8	3P1		PL 3/4x3 3/4	0 6 5/16	A36	40	
8	3P2		PLATE			40	
8	3P2		PL 3/4x3 3/4	0 6 5/16	A36	40	
8	3P3		PLATE			45	
8	3P3		PL 3/4x3 3/4	0 7	A36	45	
8	3P4		PLATE			45	
8	3P4		PL 3/4x3 3/4	0 7	A36	45	
4	3P5		PLATE			18	
4	3P5		PL 3/4x3 3/4	0 5 1/2	A36	18	
4	3P6		PLATE			18	
4	3P6		PL 3/4x3 3/4	0 5 1/2	A36	18	
2	3P7		PLATE			18	
2	3P7		PL 3/4x3 3/4	1 0 11/16	A36	18	
2	3P8		PLATE			18	
2	3P8		PL 3/4x3 3/4	1 0 11/16	A36	18	
2	3P9		PLATE			9	
2	3P9		PL 3/4x3 1/2	0 6 5/16	A36	9	
2	3P10		PLATE			9	
2	3P10		PL 3/4x3 1/2	0 6 5/16	A36	9	
2	3P11		PLATE			9	
2	3P11		PL 3/4x3 1/2	0 6 5/16	A36	9	
2	3P12		PLATE			9	
2	3P12		PL 3/4x3 1/2	0 6 5/16	A36	9	
2	3P13		PLATE			13	
2	3P13		PL 3/4x3 3/4	0 9 1/4	A36	13	
2	3P14		PLATE			4	
2	3P14		PL 3/4x2 11/16	0 3 3/4	A36	4	
2	3P15		PLATE			13	
2	3P15		PL 3/4x3 3/4	0 9 1/4	A36	13	
2	3P16		PLATE			4	
2	3P16		PL 3/4x2 11/16	0 3 3/4	A36	4	
Total weight :						310	

REV	DATE	DESCRIPTION
PROJECT NUMBER 22121		
DATE 12-5-22		
DRAWN BY KAY ENGINEERING		
CHECKED BY		
APPROVED BY		
SCALE		

